

XX COMMONWEALTH GAMES

A tiny bit of the overall project.

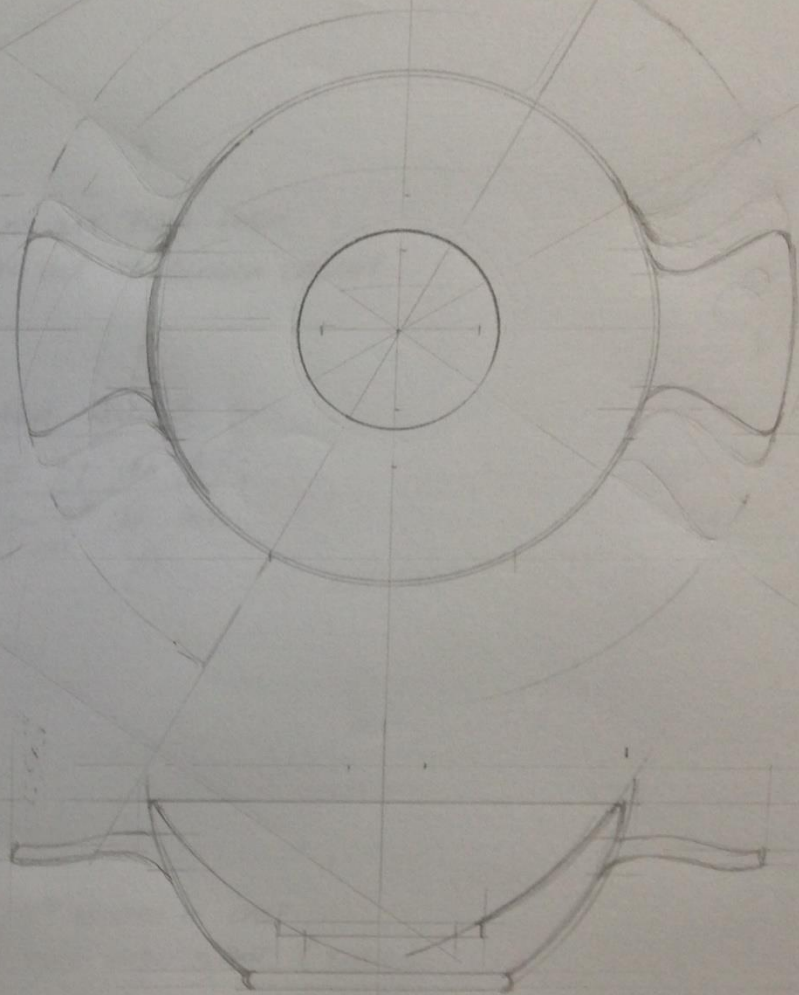

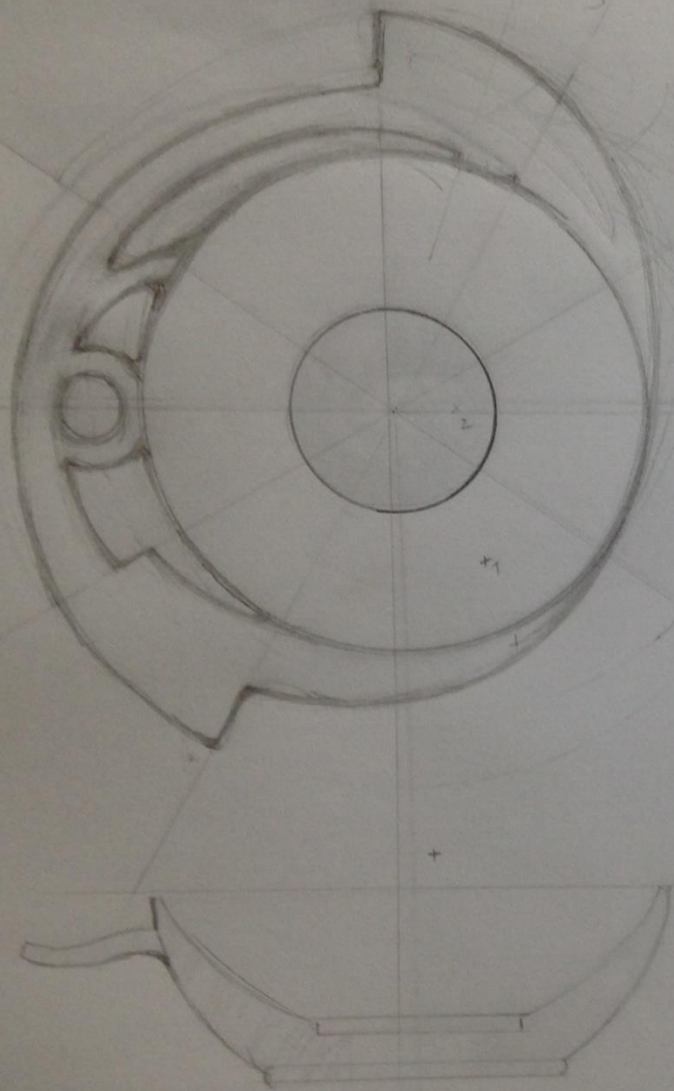

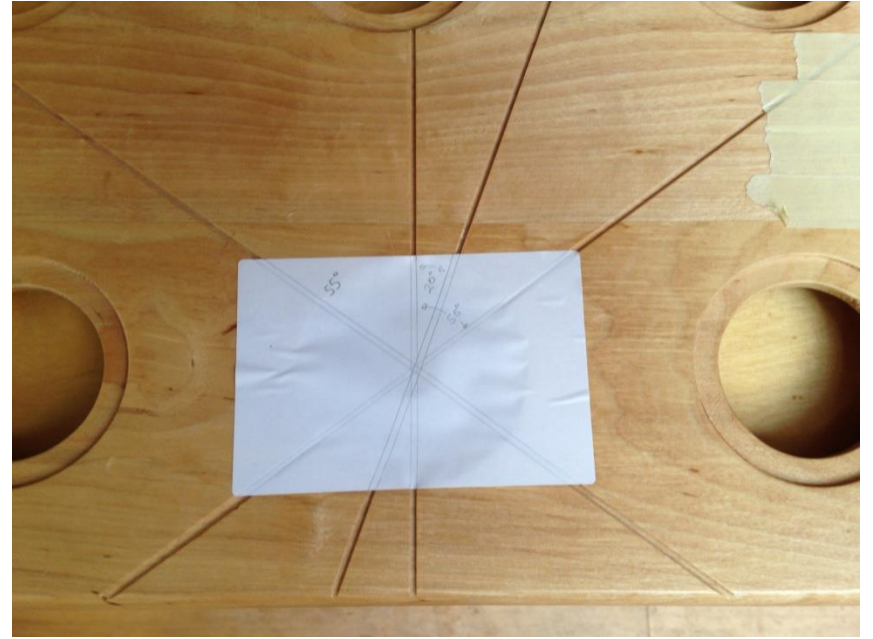





















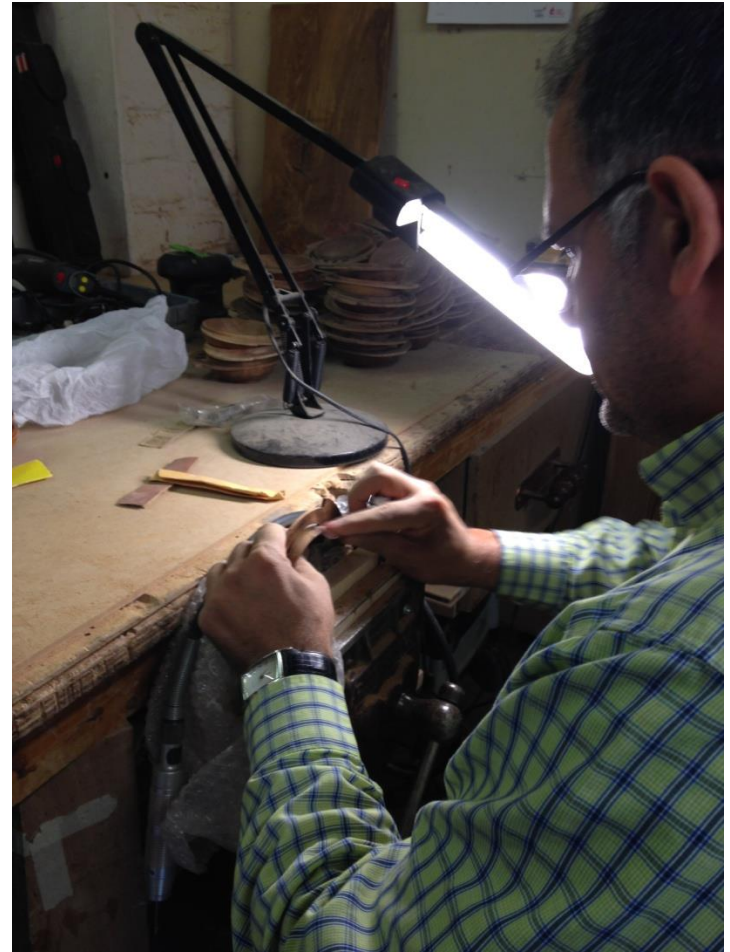





MEDAL TRAYS



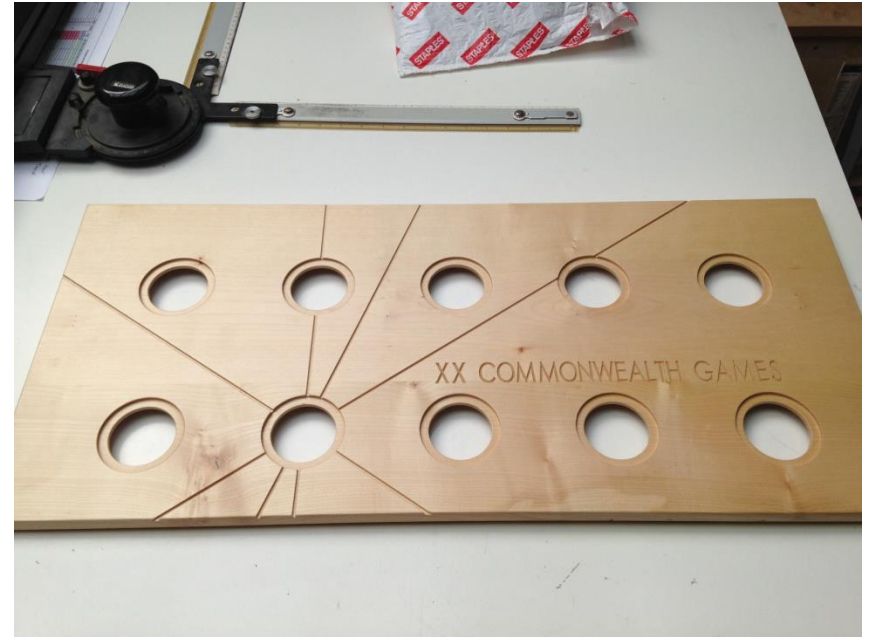
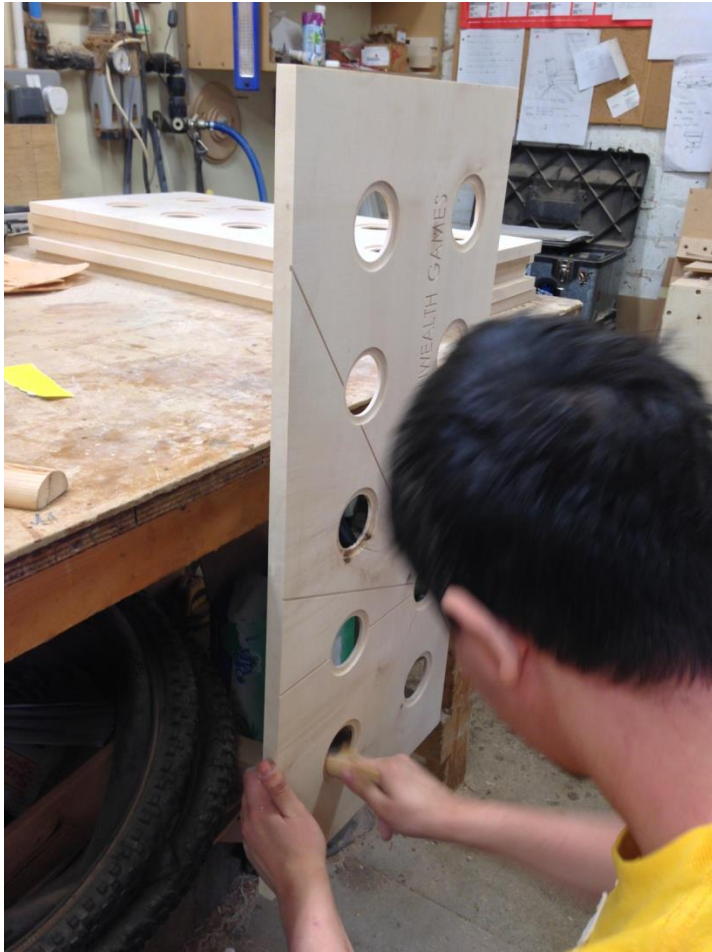

PODIUMS



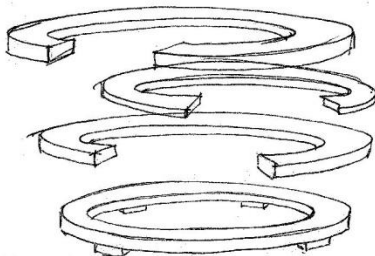

2nd + 3rd - LAYERS OF CIRCLES - SOME STOP + START - LIKE THE LOGO.

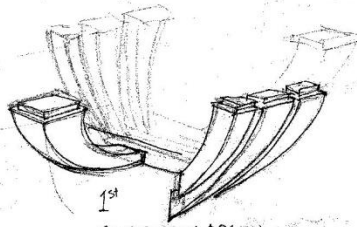

1st
CONSTRUCTION DESIGN - UNDER DEVELOPMENT -

POINT = COMPONENTS ARE LIKE TRADITION SHIP BUILDING
= THEY HAVE STRIKING RESEMBLANCE TO THE VERY BONES OF BOATS.
(GLASGOW - INDUSTRIAL / SHIP BUILDING).

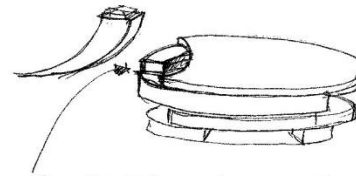

PATCH RELEVANT TO VENUE etc. TO BE PLACED IN 'SLOT' POST GRIVES
THE PATCH COULD HAVE ENGRAVING OF SOME
SET - EACH ONE DIFFERENT.

FOR EMPIRE - TO BE USED AS SEATING IN A DIFFERENT PUBLIC SPACE -
THE PATCH WOULD BE THE MEMORY OF THE VENUE / ATHLETES etc.

CONCEPT FOR PODIUMS.
1st STAGE CONSTRUCTION DESIGN.
14/12/13. P.H.
SCALE 1:10 + 1:1 = A3

DESIGN INVOLVES 'BATCH COMPONENT PRODUCTION'
THIS COULD BE PRODUCED BY BUNDO CRAFT FOR EXAMPLE

LASER ETCHING FOR
LOGO WRAPPING

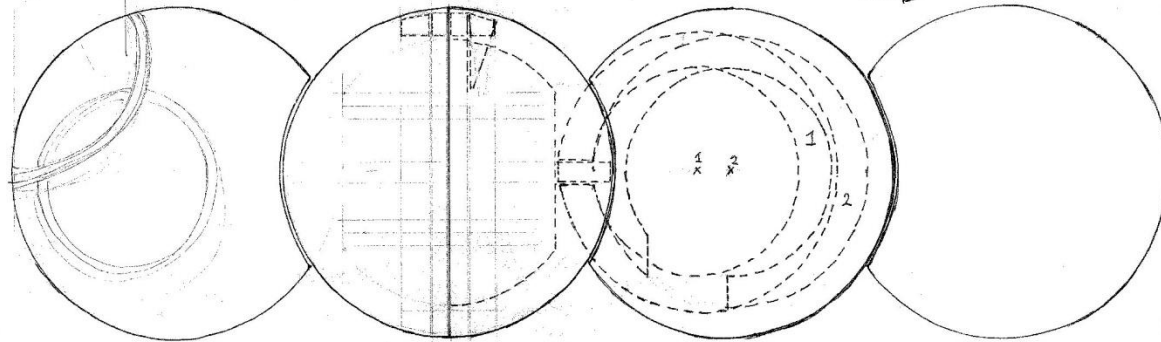

BEARER BEAMS
STAYED SEPARATELY

POWDER/LIME - LIGHT WEIGHTED
TIMBERS FOR KINGS

ASH - STRENGTH FOR TOP - FUTURE USE.

PAH - EASY TO FIND GLASGOW WOOD.

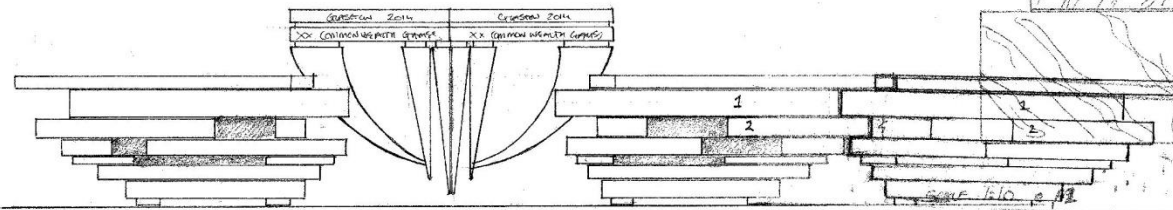

76mm BEARERS.

FOR EXTENDING
1st.

SOME 1:1

SECTION OF EDGE OF TOP. OF 1st.

RETRO FIT LEGS FOR 1st + RAISE BY 150 = 'EATING HEIGHT' - PUBLIC FURNITURE - FUTURE USE - TABLES, DISPLAY etc.

2nd + 3rd ARE - BENCH SEATING HEIGHT. - SEATING FOR FUTURE USE - COULD END UP AS SEATING, EXHIBITION PLINths etc.



















